

ELASTIQUE RUBBER CASTER SERIES



VERSATILE. RELIABLE. AFFORDABLE.

An expansive line of high performance, high capacity casters

The Elastique Caster Series is an innovative family with a soft, non-marking wheel and roller bearings. This elastic rubber wheel material has fantastic abrasion resistance which increases impact absorption, provides great floor protection, reduces noise, sheds debris, and extends service life.

APPLICATIONS



Road Cases



Utility Carts



Dollies



Sensitive Equipment



Display Units



Food Service Carts

1600 Bishop St, Cambridge, ON N1R 7N6
P: (519) 623-9420 F: (519) 653-8772

2820 Argentia Rd, Unit 3 Mississauga L5N 8G4
P: (905) 673-9500 F: (905) 673-5055



COLSON.CA

177 Rue Barr, St Laurent, QC H4T 1W6
P: (514) 735-5136 F: (514) 735-9756

112-669 Ridley Pl, Delta, BC V3M 6Y9
P: (604) 517-5858 F: (604) 517-5848

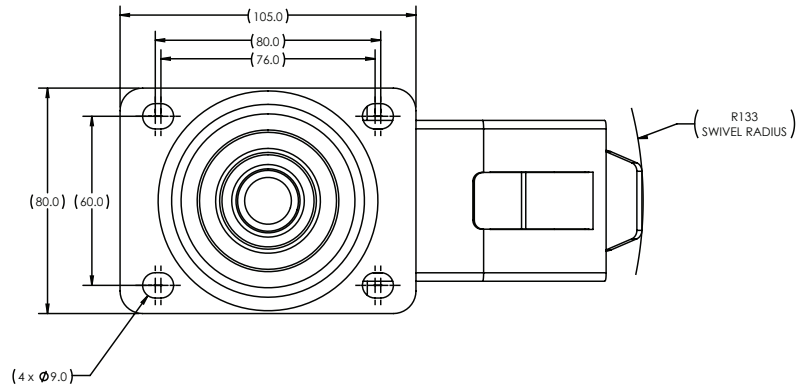
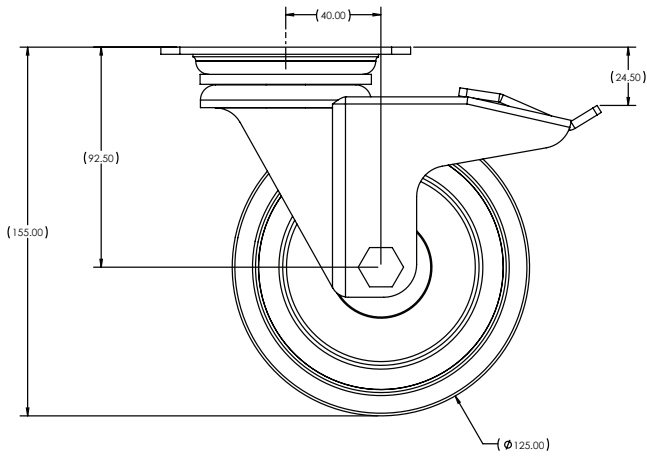

| Part Number | Wheel Size | Description | Capacity | Top Plate | Bolt Pattern | Load Height |
|-------------|------------|----------------------------|----------|-----------------|-----------------|-------------|
| E322RB | 3"x1 1/4" | Swivel | 220 lbs. | 3 1/8" x 4 1/8" | 2 3/8" x 3 1/8" | 4 1/8" |
| E322RB-SWB | 3"x1 1/4" | Swivel w/ Total Lock Brake | 220 lbs. | 3 1/8" x 4 1/8" | 2 3/8" x 3 1/8" | 4 1/8" |
| E329RB | 3"x1 1/4" | Rigid | 220 lbs. | 3 1/8" x 4 1/8" | 2 3/8" x 3 1/8" | 4 1/8" |
| E422RB | 4"x1 1/4" | Swivel | 330 lbs. | 3 1/8" x 4 1/8" | 2 3/8" x 3 1/8" | 5" |
| E422RB-SWB | 4"x1 1/4" | Swivel w/ Total Lock Brake | 330 lbs. | 3 1/8" x 4 1/8" | 2 3/8" x 3 1/8" | 5" |
| E429RB | 4"x1 1/4" | Rigid | 330 lbs. | 3 1/8" x 4 1/8" | 2 3/8" x 3 1/8" | 5" |
| E522RB | 5"x1 1/4" | Swivel | 440 lbs. | 3 1/8" x 4 1/8" | 2 3/8" x 3 1/8" | 6 1/8" |
| E522RB-SWB | 5"x1 1/4" | Swivel w/ Total Lock Brake | 440 lbs. | 3 1/8" x 4 1/8" | 2 3/8" x 3 1/8" | 6 1/8" |
| E529RB | 5"x1 1/4" | Rigid | 440 lbs. | 3 1/8" x 4 1/8" | 2 3/8" x 3 1/8" | 6 1/8" |
| E622RB | 6"x1 7/8" | Swivel | 660 lbs. | 4 1/4" x 5 1/4" | 3" x 4 1/8" | 7 1/4" |
| E622RB-SWB | 6"x1 7/8" | Swivel w/ Total Lock Brake | 660 lbs. | 4 1/4" x 5 1/4" | 3" x 4 1/8" | 7 1/4" |
| E629RB | 6"x1 7/8" | Rigid | 660 lbs. | 4 1/4" x 5 1/4" | 3" x 4 1/8" | 7 1/4" |
| E822RB | 8"x1 7/8" | Swivel | 770 lbs. | 4 1/4" x 5 1/4" | 3" x 4 1/8" | 9 1/4" |
| E822RB-SWB | 8"x1 7/8" | Swivel w/ Total Lock Brake | 770 lbs. | 4 1/4" x 5 1/4" | 3" x 4 1/8" | 9 1/4" |
| E829RB | 8"x1 7/8" | Rigid | 770 lbs. | 4 1/4" x 5 1/4" | 3" x 4 1/8" | 9 1/4" |



CGP108CA.0125.r2
© Copyright 2025 | Colson Group

Specifications subject to change without notice.

1600 Bishop St, Cambridge, ON N1R 7N6
P: (519) 623-9420 F: (519) 653-8772

2820 Argentia Rd, Unit 3 Mississauga L5N 8G4
P: (905) 673-9500 F: (905) 673-5055



COLSON.CA

177 Rue Barr, St Laurent, QC H4T 1W6
P: (514) 735-5136 F: (514) 735-9756

112-669 Ridley Pl, Delta, BC V3M 6Y9
P: (604) 517-5858 F: (604) 517-5848