



MADE-IN-THE-USA PRODUCT CATALOG

GLOBAL EXPERTISE DOMESTIC MANUFACTURING



AMERICAN-MADE **CASTERS** AND **WHEELS** SINCE 1878

ColsonGroupUSA.com

CASTER COMPONENTS

RIG CONSTRUCTION

KINGPIN RIG

CONVENTIONAL CONSTRUCTION

• UP TO 2,000 LB. CAPACITY

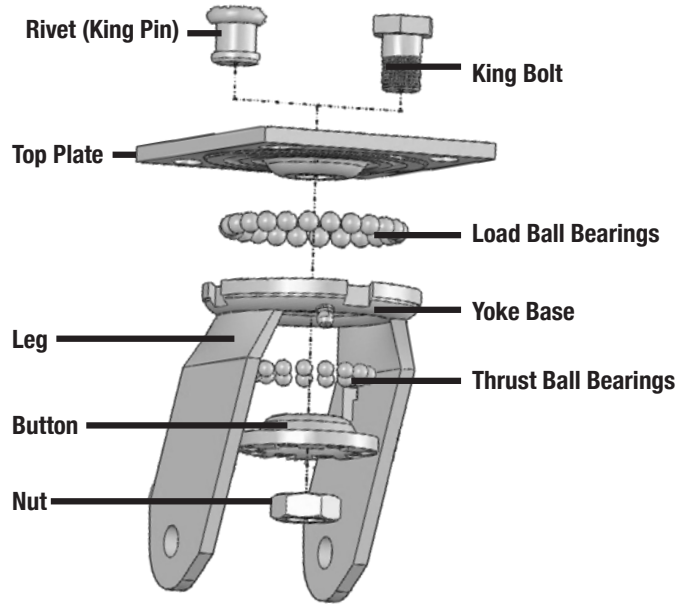

KINGPINLESS RIG

BETTER ERGONOMICS, BEST FOR SHOCK AND IMPACT

• UP TO 20,000 LBS. CAPACITY

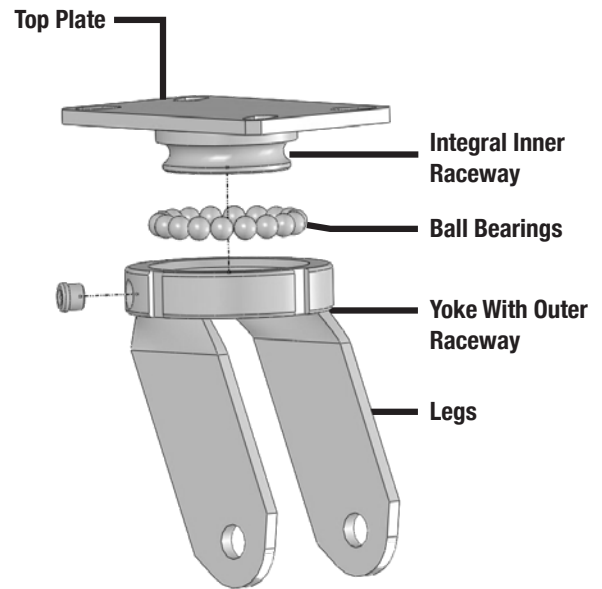

MAINTENANCE FREE SWIVEL SECTION

SEALED PRECISION SWIVEL BEARING PROVIDES EXCELLENT ERGONOMICS WITH NO MAINTENANCE

• UP TO 2,000 LBS. CAPACITY

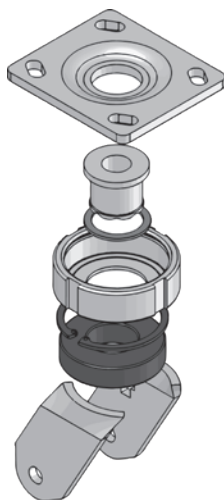

WHEEL

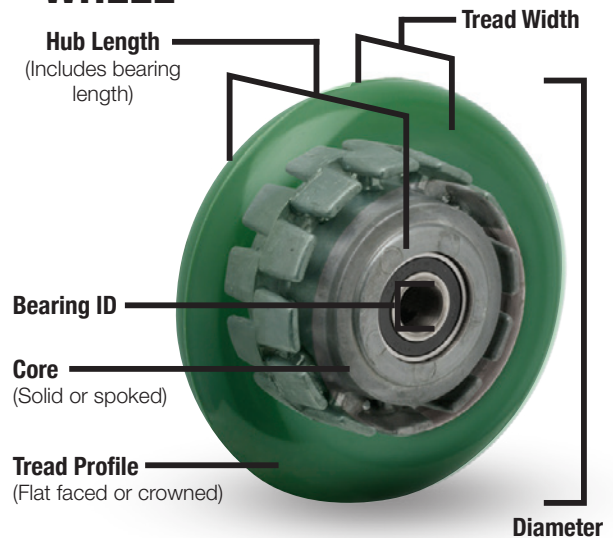

Need help determining the right solution for your application?
Let us help! Connect with us online at www.albioncasters.com
or call us at **800-835-8911**.

Wheel Material

Selecting the right wheel can make a big difference in the performance and life of your caster. To determine what material would work best for your application, please review the below material descriptions and features.

Polyurethane capacities up to 10,900 lbs

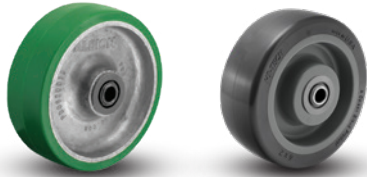

Description:

Albion's polyurethane wheels are uniquely formulated and open cast or injection molded to clean, close tolerance cores. Each unique formula is designed for specific mobility benefits, including: ergonomics, shock absorption, noise reduction, debris rejection, and overall durability.

Features:

- » Non-marking, floor protective
- » Resists chemicals and oils
- » Excellent capacity, wear resistance, and strength
- » Quieter and more shock absorbing than metal wheels
- » Designated wheels are towable
- » Various durometers, thicknesses, tread profiles and colors available

Rubber capacities up to 3,630 lbs



Description:

Rubber wheels provide exceptional floor protection, shock absorption, and our more advanced formulas even reject metal shavings and debris (Performa, SZ/SV). Various options can be found throughout our rubber wheel offering, including: non-marking formulas, no-maintenance/semi/fully pneumatic wheels, and a variety of durometers and color choices.

Features:

- » Floor protection
- » Quiet mobility
- » Cost effective
- » Shock absorption
- » Indoor/outdoor use (pneumatic family)

Phenolic capacities up to 8,000 lbs



Description:

Phenolic wheels are constructed of heavy macerated materials impregnated with phenolic resins – and then molded under high heat and pressure to produce a quality, but economical industrial wheel.

Features:

- » High load capacities
- » Resistant to chemicals and oils
- » Impact resistant
- » Economical
- » High-temp options

Glass Filled Nylon capacities up to 7,200 lbs



Description:

Offering high load capacities and greater floor protection than conventional metal or phenolic wheels, our range of Nylon and Glass-Filled wheels are a perfect fit for helping reduce wheel noise or in clean applications requiring frequent wash downs.

Features:

- » High load capacities
- » Impact resistant
- » Corrosion resistant
- » Resistant to chemicals and oils
- » High-temp options

HEAVY DUTY KINGPINLESS CASTERS

CAPACITY UP TO 5,400 LBS

Common Applications:

- Conveyor-Drawn Tow-Trucks
- Heavy Duty Bakery Racks
- Production Dollies
- Heavy Duty Dough Troughs
- Body Dolly Carts
- Engine Dollies
- Material Carts
- Aircraft Maintenance Stands
- Aircraft Engine Stands



Kingpinless Casters **ELIMINATE** KINGPIN FAILURE

Kingpinless casters are ideal for power-towed applications, handling shock and impact better than traditional kingpin casters. Their precision-machined raceway with ball bearings ensures smoother swiveling, greater load distribution, and eliminates the primary failure point found in conventional swivel designs.

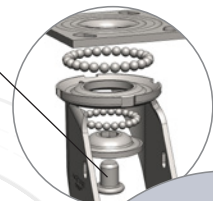

85% of Caster failures are due to Kingpin Failure.

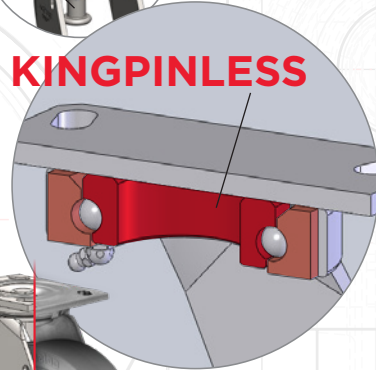

Albion 310 Series
Heavy Duty Kingpinless Caster

Albion 410 Series
Heavy Duty Kingpinless Caster

DOWNLOAD 3D CAD MODELS & DATASHEETS

ONLINE APP STORE
ColsonCaster.com Search: "Caster CAD 3D"

KINGPINLESS

110

Kingpinless Casters CAPACITY TO 2000 LBS



ALBION



Premium Quality



Towing[^]



Ergonomic

ACCESSORIES

To order, add brake code below to end of model. Example: 110XS06201S**CB110**

Cam brake
specify **CB110**



PLB Integrated brake
specify **PLB**
(6" and 8" models only)

Face brake
specify **FBC** (Not available with swivel lock)



Face brake
specify **FBE**

Face brake
specify **FBK**



Poly Cam brake
specify **P**



Swivel Lock
Hand operated field installable swivel lock order **SL16000013A** separately for standard plate. For PATK optional top plate use **SL160000K**



Foot operated field installable **swivel lock** order **SL160002** separately

Field installable toe guards See page 23 for model numbers



Precision raceways and fully heat treated construction make the 110 Series the ideal solution for applications exposed to rugged conditions or high amounts of impact and shock. More durable than competitors' case or induction hardened construction, and longer lasting than conventional kingpin designs.

TYPICAL APPLICATIONS

- Dollies
- Dough troughs
- Platform trucks
- Tow line
- Utility carts
- Tooling fixtures
- Scrap metal carriers

MOUNTING OPTIONS

Standard Plate

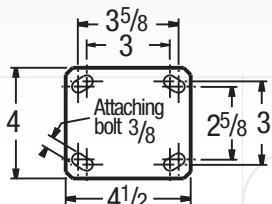

Additional plate options available. Consult factory.

FEATURES

- 3 Year warranty
- **Top Plate:** 5/16" AISI 1045 steel welded and heat treated for longer life
- **Swivel Section:** One row of 3/8" ball bearings mounted in a **heat treated** precision machined raceway. Zerk in swivel section
- **Yoke Base:** Notched AISI 1045 steel
- **Axle:** 1/2" diameter hollow axle with zerk fitting on roller and tapered bearing models (Solid axle on precision bal models)
- **Finish:** Zinc plating
- Alternate or custom caster configurations available

BEARING OPTIONS



Straight Roller (01)



Precision Ball (28)

RIG OPTIONS

- **Optional Swivel Leads:** of 2-1/4" for 6" casters and 3-1/2" for 8" casters. Only available in 6" with 7-1/2" overall heights and 8" and 10-1/8" overall heights. To order, add X to end of model number. Consult factory for specification support, as load capacities may reduce based on application or equipment design.

SWIVEL CROSS SECTION

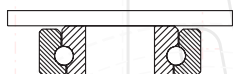

Wheel Selection



310

Kingpinless Casters

CAPACITY TO 4100 LBS



ALBION



Premium Quality



Towing[^]



Environmentally Friendly
(Consult factory)



Constructed from high quality, heat treated AISI 1045 laser-cut steel. Precision machined raceway, fully welded legs (inside and outside), and kingpinless design delivers superior strength in rugged applications.

TYPICAL APPLICATIONS

- Conveyor-drawn tow-trucks
- Heavy duty bakery racks
- Production dollies
- Heavy duty dough troughs

MOUNTING OPTIONS

Standard Plate

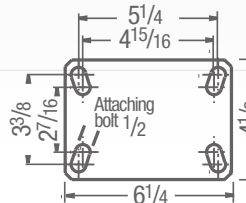

Additional plate options available.
Consult factory.

SWIVEL CROSS SECTION



FEATURES

- **Integral laser cut design**
- **3 Year warranty**
- **Top Plate:** 5/16" AISI 1045
- **Swivel Section:** One row of 1/2" ball bearings mounted in a heat treated precision machined raceway. Zerk in swivel section
- **Yoke Base:** Notched AISI 1045 steel
- **Legs:** 3/8" thick welded inside and out
- **Axle:** 3/4" diameter
- **Finish:** RoHS Zinc plating, for greater corrosion resistance than paint
- Alternate or custom caster configurations available

ACCESSORIES

To order, add brake code below to end of model. Example: 310PY08401SP

Poly Cam brake
specify **P**



PLB Integrated brake
specify **PLB**

Face brake
specify **FBB**



Face brake
specify **F**

BEARING OPTIONS

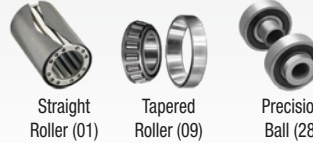

Straight Roller (01)

Tapered Roller (09)

Precision Ball (28)

Hand operated field installable swivel lock
order **SL3000000** separately



Field installable toe guards
See page 23 for model numbers

RIG OPTIONS

- **Optional Towable Swivel Leads:** Consult factory for optional towing leads
- **Optional Spring Loaded:** Spring loaded casters offer improved product protection and reduce noise.



TOE GUARD

Specify **TO** for caster integrated toe guard. Standard model toe guards are 1/2" from the floor.



Wheel Selection



410

Kingpinless Casters

CAPACITY TO 5400 LBS



ALBION®



Premium Quality



Towing[^]



Environmentally Friendly
(Consult factory)



Constructed from high quality, heat treated AISI 1045 laser-cut steel. Precision machined raceway, fully welded legs (inside and outside), and kingpinless design delivers superior strength in rugged applications.

FEATURES

- **Integral laser cut design**
- **3 Year warranty**
- **Top Plate:** 3/8" AISI 1045
- **Swivel Section:** One row of 1/2" ball bearings mounted in a heat treated precision machined raceway. Zerk in swivel section
- **Yoke Base:** Notched AISI 1045 steel
- **Legs:** 3/8" thick welded inside and out
- **Axle:** 3/4" diameter
- **Finish:** RoHS Zinc plating, for greater corrosion resistance than paint
- Alternate or custom caster configurations available

RIG OPTIONS

- **Optional Spring Loaded:** Spring loaded casters offer improved product protection and reduce noise.



ACCESSORIES

To order, add brake code below to end of model. Example: 410PY08501SP

Poly Cam brake specify **P**



PLB Integrated brake specify **PLB**

Face brake specify **FBB**



Face brake specify **F**



Hand operated field installable **swivel lock** order **SL4000000** separately



Field installable toe guards See page 23 for model numbers

TYPICAL APPLICATIONS

- Conveyor-drawn tow-trucks
- Heavy duty bakery racks
- Production dollies
- Heavy duty dough troughs

MOUNTING OPTIONS

Standard Plate

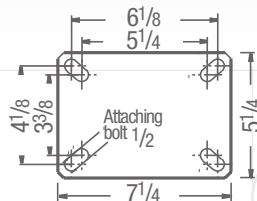

Additional plate options available. Consult factory.

BEARING OPTIONS

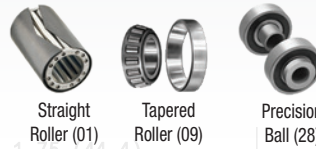

TOE GUARD

Specify **TO** for caster integrated toe guard. Standard model toe guards are 1/2" from the floor.



SWIVEL CROSS SECTION



Wheel Selection



MAINTENANCE FREE KINGPINLESS CASTERS

CAPACITY UP TO 2,500 LBS



Common Applications:

- Production Racks and Carts
- Conveyor Systems
- Part Carts
- Tool Dollies
- Floor Trucks
- Warehouse Trucks
- Distribution Cages and Carts



Maintenance Free Advantage

- Ergonomically designed
- Easier push/pull force
- Quieter operation
- Reduced maintenance costs
- Long life in towing application (28-38 Series)

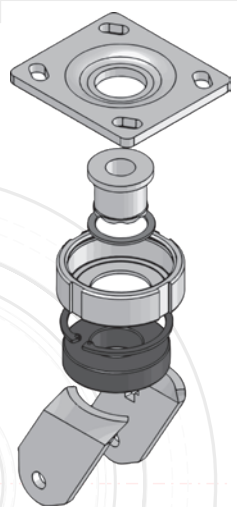

Albion 28 Series
Maintenance Free Kingpinless Caster

Albion 38 Series
Maintenance Free Kingpinless Caster

DOWNLOAD
3D CAD MODELS
& DATASHEETS

ONLINE APP STORE
ColsonCaster.com Search: "Caster CAD 3D"

28 Maintenance Free Ergonomic Precision Casters

CAPACITY TO 1500 LBS



ALBION



- Quiet
- Ergonomic
- Maintenance Free
- Premium Quality
- Environmentally Friendly (Consult factory)

FEATURES

- Maintenance Free:** Maintenance free swivel section. No lubrication ever needed
- Ergonomic Extended Lead:** Extended lead is standard, improving ergonomics, reducing push / pull force
- Top Plate & Yoke Base:** Cold formed from 1/4" steel plate. Yoke base is notched for field installable 4-position swivel lock
- Legs:** 1/4" steel, formed to increase strength and welded on inside and outside of yoke base
- Finish:** All parts, except wheel, are zinc plated
- Axle:** 1/2" diameter solid axle with lock nut

ACCESSORIES

To order, add brake code below to end of model. Example: 28AN06228S**FBK**

FBK Face brake for swivel models; field installable



SL1600013A Hand operated field installable swivel lock

TO Factory installed integral toe guard, available on swivel and rigid.



Field installable toe guards

PBTO New integrated brake/toe guard



TYPICAL APPLICATIONS

- Automated guide vehicles
- Hand Push Carts
- Towing Carts
- Lean / JIT cart programs
- Tow Line Applications
- Warehouse Applications

MOUNTING OPTIONS

Standard Plate

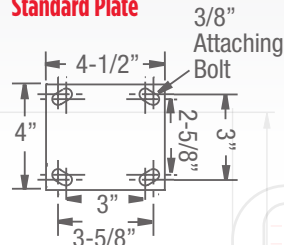

Additional plate options available. Consult factory.

BEARING OPTIONS



Precision Ball (28)
No lubrication required

Wheel Selection



38

Maintenance Free Ergonomic Precision Casters CAPACITY TO 2200 LBS



ALBION



Quiet



Ergonomic



Maintenance Free



Premium Quality



Environmentally Friendly
(Consult factory)

FEATURES

- **Maintenance Free:** Maintenance free swivel section. No lubrication ever needed
- **Ergonomic Extended Lead:** Extended lead is standard, improving ergonomics, reducing push / pull force
- **Top Plate & Yoke Base:** 5/16" HSLA steel plate. Yoke base is notched for field installable 4-position swivel lock
- **Legs:** 1/4" steel, formed to increase strength and welded on inside and outside of yoke base
- **Finish:** All parts, except wheel, are zinc plated
- **Axle:** 1/2" diameter solid axle with lock nut

ACCESSORIES

To order, add brake code below to end of model. Example:
38AN06228S**FBK**

FBK Face brake for swivel models; field installable



PB Face Brake New integrated face brake



SL3000000

Hand operated field installable **swivel lock** order separately



Field installable toe guards

TO Factory installed integral toe guard, available on swivel and rigid.



Heavier duty ergonomic design with extended leads for ease of movement and quiet mobility. Sealed precision swivel bearing is maintenance free and significantly reduces push/pull force, keeping equipment operators safer and improving efficiency.

TYPICAL APPLICATIONS

- Automated guide vehicles
- Hand Push Carts
- Towing Carts
- Lean / JIT cart programs
- Tow Line Applications
- Warehouse Applications

MOUNTING OPTIONS

Standard Plate

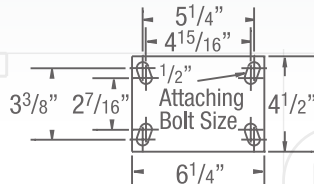

Additional plate options available. Consult factory.

BEARING OPTIONS



Precision Ball (28)
No lubrication required



18 Series

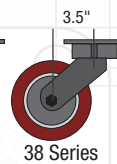

38 Series

Extended swivel lead on 38 series casters reduce "push / pull" force and eliminate chatter in tow applications

Wheel Selection





MEDIUM DUTY CASTERS

CAPACITY UP TO 1,250

Common Applications:

- Hospitality
- Institutional
- Retail Environment
- Automotive
- Manufacturing
- Material Handling
- Warehouse & Distribution



Albion 16 Series
Medium Duty Caster

Colson 4 Series
Medium Duty Caster

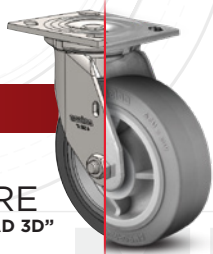

**DOWNLOAD
3D CAD MODELS
& DATASHEETS**

ONLINE APP STORE
ColsonCaster.com Search: "Caster CAD 3D"

MEDIUM DUTY

4 Series

MEDIUM DUTY Swivel & Rigid
Capacity up to 1250 lbs each



colson



ACCESSORIES



BRK1 Tread Lock
Available on all swivel casters except 3 1/4" diameter and V-Groove models.



BRK2 Tech Lock®
Available on all swivel casters except 3 1/4" diameter, V-Groove and Swivel Lock models. 6" rigid model available.



BRK3 Side Lock
Available on all swivel roller bearing or one piece Delrin models except 3 1/4" diameter



BRK4 Total Lock
Available on 4", 5", 6" & 8" swivel models except 3 1/4" diameter and V-Groove wheels



BRK7 Top Lock
(See page 88)
Available on 4", 5", 6" and 8" swivel models except V-Groove

FEATURES

- All caster forks and many wheels USA-made for highest quality and quick delivery
- Attractive zinc plated finish
- Full double ball hardened raceways
- 1/2" hollow axle with grease zerk and lock nut
- Plastic seal/retainer washer (roller bearing models)
- 1/4" steel top plate for durability
- Permanent rivet kingpin with 5/8" diameter rivet
- Grease fittings: wheel bearing and swivel raceway
- Multi-temp grease lubricates in extreme hot and cold temperatures

Colson 4 Series casters are our most popular and requested 2"-wide casters for industrial applications. Colson 4 Series caster rigs are manufactured in the USA for the highest available quality and quickest delivery options. Zinc plating provides an attractive and durable finish for corrosion resistance.

STANDARD PLATE

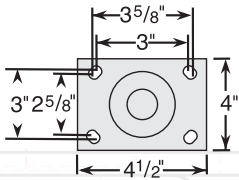

Additional plate options available. Consult factory.

RIG OPTIONS



MTG81 Foot Activated Swivel Lock
Available on all swivel casters with standard top plate **MTG81**



Hand Activated Swivel Lock
Available on all swivel casters in Bolt-On or Welded design.

SEAL DirtBan Swivel Seal
Not available on swivel lock models

TG1/TG2 Thread Guards
Available on many models (TG1 for metal or TG2 for plastic).

Load Height Option
6" dia. models with 7 1/4" load height. Only Side Lock brakes

BEARING OPTIONS



Straight Roller (01) Drawn Cup Roller (02) Oillex (23)

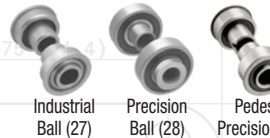

Industrial Ball (27) Precision Ball (28) Pedestal Precision (29)



1-Piece Delrin (52) 2-Piece Delrin (51) Bronze (22)



Consult factory for RoHS requirements on a part specific basis.



Consult the NSF listing page on a part specific basis for NSF requirements.

SWIVEL CROSS SECTION

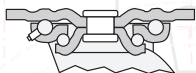

Wheel Selection



16

Medium Heavy Duty Casters

CAPACITY UP TO 1250 LBS



ALBION



Premium Quality



Environmentally Friendly (Consult factory)



The 16 Series features a quality USA made rig and 3-year warranty, along with the most wheel and brake options in the industry. This quality lineup provides lasting value, all at a competitive price.

TYPICAL APPLICATIONS

- Shop/Distribution Carts
- Dollies
- Waste disposal trucks
- Warehouse trucks
- Floor Trucks

RIG OPTIONS

- Upper/lower raceway rubber seals help protect casters
- Optional overall heights

MOUNTING OPTIONS

Standard Plate

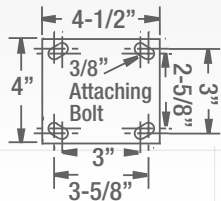

Additional plate options available. Consult factory.

SWIVEL CROSS SECTION

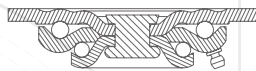

FEATURES

- **Maintenance Free:** Maintenance free swivel section. No lubrication ever needed
- **Ergonomic Extended Lead:** Extended lead is standard, improving ergonomics, reducing push / pull force
- **Top Plate & Yoke Base:** Cold formed from 1/4" steel plate. Yoke base is notched for field installable 4-position swivel lock
- **Legs:** 1/4" steel, formed to increase strength and welded on inside and outside of yoke base
- **Finish:** All parts, except wheel, are zinc plated
- **Axle:** 1/2" diameter solid axle with lock nut

BEARING OPTIONS

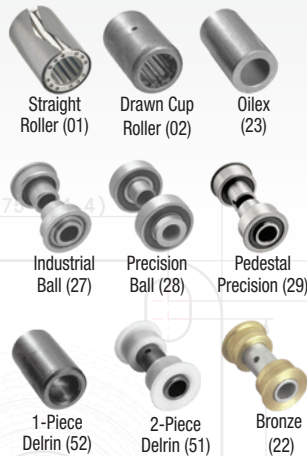

ACCESSORIES

To order, add brake code below to end of model. Example: 28AN06228ST

Total Lock brake specify T (4" to 8" models) specify optional 7 1/2" (HS60) overall height model if ordering 6"



SS02 Raceway grease seals



Consult factory for RoHS requirements on a part specific basis.



Consult the NSF listing page on a part specific basis for NSF requirements.

Wheel Selection





LIGHT DUTY CASTERS

CAPACITY RANGE UP TO 500 LBS

Common Applications:

- Conveyor-Drawn Tow-Trucks
- Heavy Duty Bakery Racks
- Production Dollies
- Heavy Duty Dough Troughs
- Body Dolly Carts
- Engine Dollies
- Material Carts
- Aircraft Maintenance Stands
- Aircraft Engine Stands

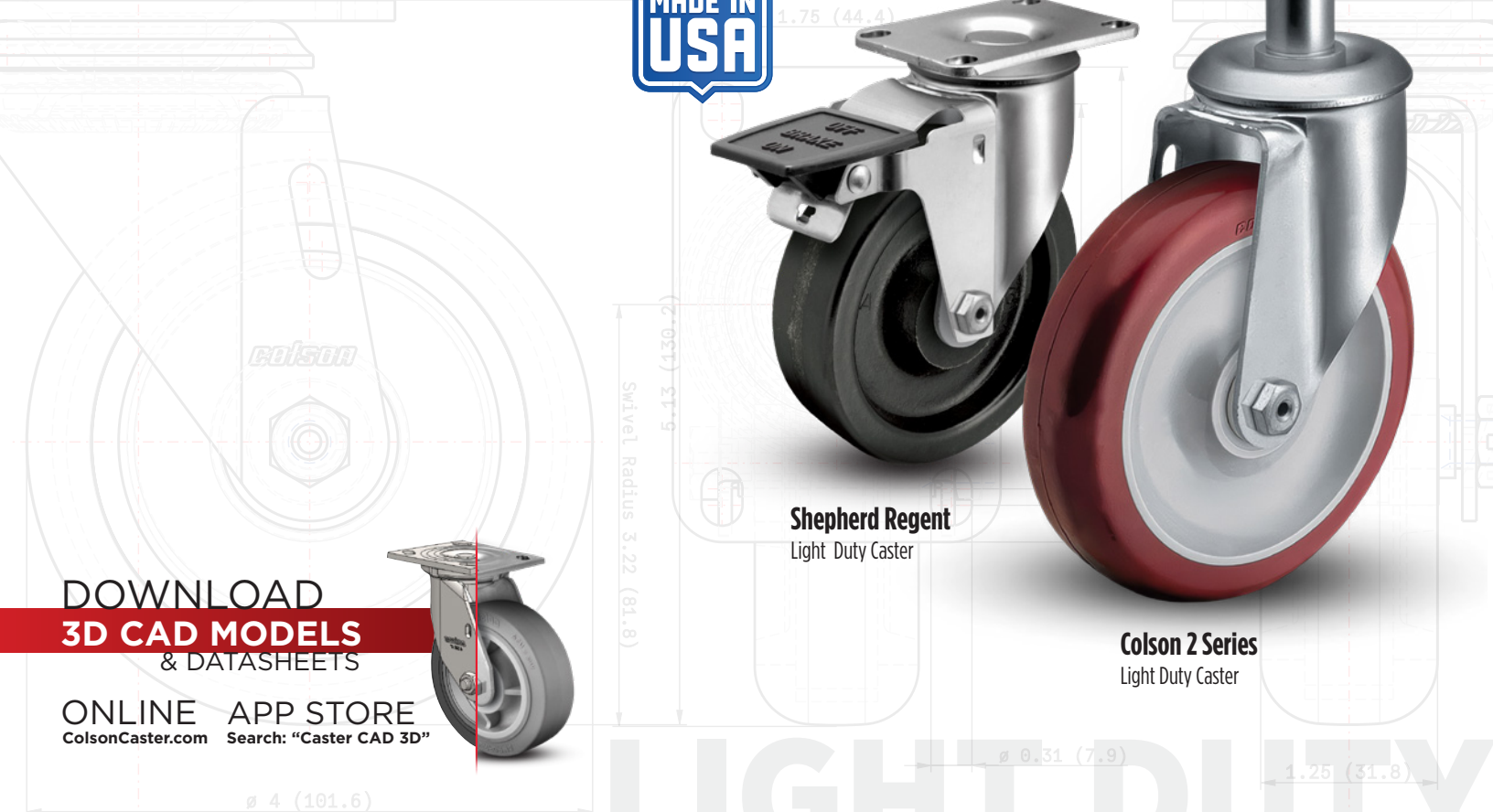

Shepherd Regent
Light Duty Caster



Colson 2 Series
Light Duty Caster

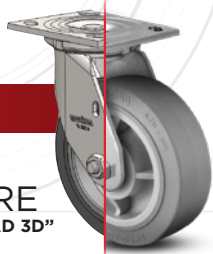

DOWNLOAD
3D CAD MODELS
& DATASHEETS

ONLINE APP STORE
ColsonCaster.com Search: "Caster CAD 3D"

LIGHT DUTY

2 Series

LIGHT DUTY Swivel & Rigid
Capacity up to 350 lbs each



colson



Premium Quality



Environmentally Friendly (Consult factory)

FEATURES

- Zinc plated finish is attractive and durable
- Full double ball hardened raceways for better performance and greater durability
- 3/8" axle with lock nut
- Multi-temp grease lubricates in extreme hot and cold temperatures

ACCESSORIES



BRK1 Top Lock
Available on all swivel models with solid axle only. Field installable



BRK8 Posi Lock
Available on all swivels. Field installable



BRK5 Total Lock
Locks wheel and swivel simultaneously. Fits 3", 3 1/2", 4", 5" and 6" swivel models. Field installable



Directional Lock
Available with standard top plate only. For optional top plates, consult factory. To order with caster, change 4th digit to "1" (Example: 2.05156.91).

Note: No Dust Cap Available.

Colson 2 Series casters are one of the most desired industrial 1-1/4"-wide caster solutions, handling working loads of up to 325 lbs. per caster. Built for lasting mobility and featuring our 3-year warranty, this series provides reliability and performance.

STANDARD PLATE

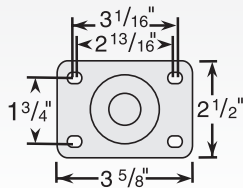

Additional plate options available. Consult factory.

MOUNTING OPTIONS

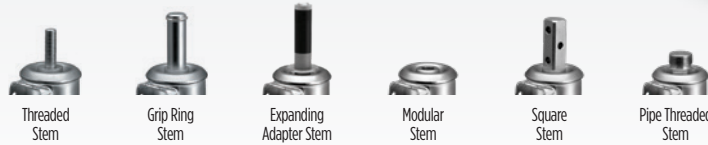

RIG OPTIONS

NSF Listed For Food Service Industry
Consult factory for details.

Swivel Dust Cap
(Specify **DC1** standard; **DC2** Dust Cap w/grease seal and zerks)

Standard Thread Guards
Full thread guards are standard on Precision Polyurethane HI-TECH (9P8) and Performa Crowned Tread (5P8). Partial Thread Guards are standard on Precision Performa Rubber Flat Tread models (4P8).

Optional Thread Guards
Available on many models. Specify **TG1** for metal or **TG2** for plastic.



Consult factory for RoHS requirements on a part specific basis.



Consult the NSF listing page on a part specific basis for NSF requirements.

SWIVEL CROSS SECTION

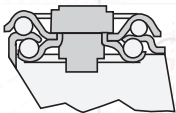

Wheel Selection

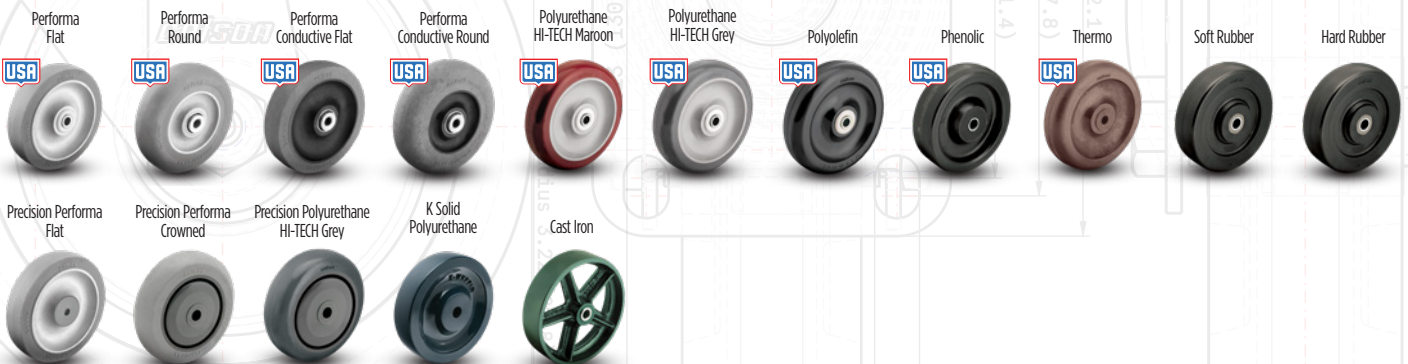

Regent

Light Duty Casters
CAPACITY UP TO 160 LBS

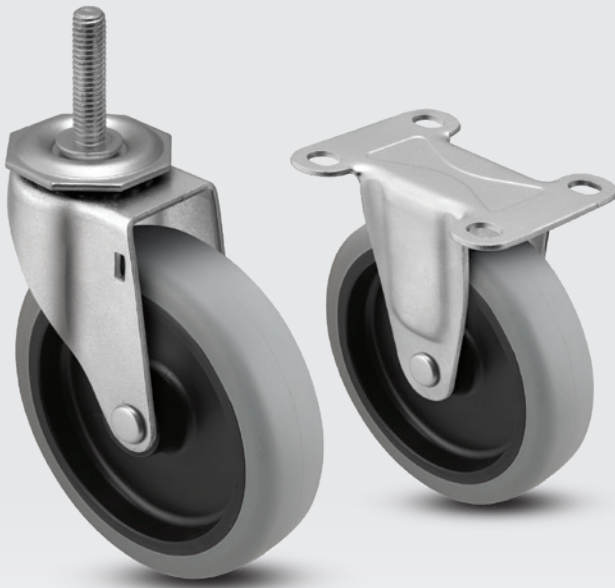

Shepherd Regent casters are USA-made with high-strength steel rigs for increased strength and durability. Multiple fastenings, wheel types, and finishes exist for the Regent series, providing great flexibility of style and usage.



FEATURES

- Industry leading selection and overall value
- Fast deliveries for any order quantity
- High-strength & heat treated steel for increased durability and caster life
- Dual ball raceways
- RoHS compliant zinc plating for corrosion resistance
- Octagon washer on stem models for easy installation
- NSF approved (less thread guards)

ACCESSORIES

To order, add brake code below to end of model. Example: PRE40120ZN-TPRB

Side Brakes for 2", 2-1/2" and 3" models. Add **[B]** at end of model.



Top Lock Brakes 3" and 4" diameter models. Add **[TL]** at end of model. Not compatible with top plate models.

Tread Lock Brakes 4" and 5" models. Add **[B]** at end of model.



Side Brakes 4" and 5" models. Add **[SB]** at end of model.

TYPICAL APPLICATIONS

- Store fixtures
- Carts
- Institutional Equipment
- Food Service Equipment
- Furniture
- Janitorial Equipment
- Office Equipment
- Racks and Storage Equipment
- Medical Equipment

MOUNTING OPTIONS



FINISH OPTIONS

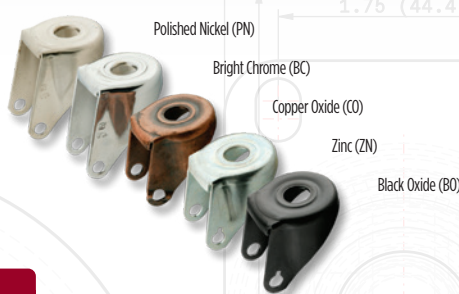

SOCKET OPTIONS

Shepherd has many solutions to help you mount your casters to your equipment quickly and easily.

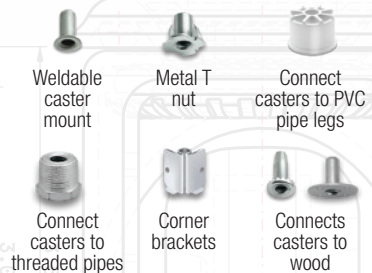

Wheel Selection



	Polyolefin	Hard or Soft Rubber	Thermoplastic Rubber (TRP)	Polyurethane (TPU)	3" No-Matic	Vipor	MonoTech	5" Precision Bearing MonoTech
Floor Protection*	✓	✓	✓+	✓+	✓+	✓+	✓+	✓+
Non-Marking	✓	✓	✓+	✓+	✓	✓+	✓+	✓+
Durability	✓+	✓	✓	✓+	✓	✓+	✓+	✓+
Cushioned Ride		✓+(soft)	✓	✓	✓+	✓	✓+	✓+
Chemical Resistance	✓+	✓	✓	✓+	✓	✓+	✓+	✓+



Consult factory for RoHS requirements on a part specific basis.



Consult the NSF listing page on a part specific basis for NSF requirements.

Monarch Light Duty Hooded Casters

CAPACITY UP TO 120 LBS



FEATURES

- Industry leading selection and overall value
- Fast deliveries for any order quantity
- High-strength & heat treated steel for increased durability and caster life
- Dual ball raceways
- RoHS compliant zinc plating for corrosion resistance
- Octagon washer on stem models for easy installation
- NSF approved (less thread guards)

ACCESSORIES

To order, add brake code below to end of model. Example: PMN20223ZN-3EB

Side Brakes for 2", 2-1/2" and 3" models. Add **[B]** at end of model.



Top Lock Brakes 3" and 4" diameter models. Add **[TL]** at end of model. Not compatible with top plate models.

Tread Lock Brakes 4" and 5" models. Add **[B]** at end of model.



Side Brakes 4" and 5" models. Add **[SB]** at end of model.

This single wheel caster series features an extended steel hood that helps protect fingers or clothing from getting pinched or entangled amongst the wheel. With a variety of fastening, size, and wheel options available- you will be sure to find the perfect caster to meet your light duty mobility needs.

TYPICAL APPLICATIONS

- Fixtures
- Institutional Equipment
- Equipment Carts
- Furniture
- Mechanical Creepers
- Seating
- Medical Equipment

MOUNTING OPTIONS

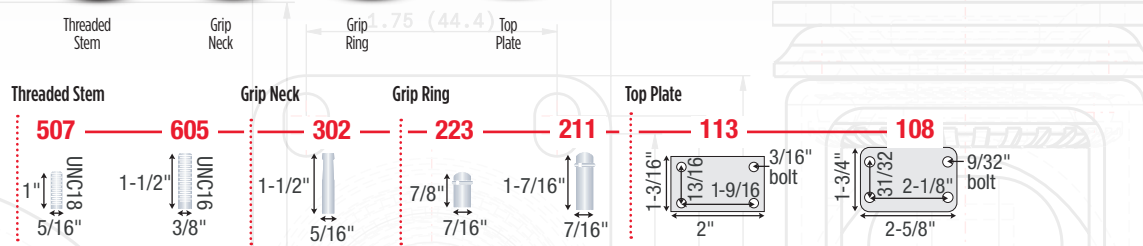

SOCKET OPTIONS

Shepherd has many solutions to help you mount your casters to your equipment quickly and easily.



Wheel Selection



	Polyolefin	Hard or Soft Rubber	Thermoplastic Rubber (TRP)	Polyurethane (TPU)	3" No-Matic	Vipor	MonoTech	5" Precision Bearing MonoTech
Floor Protection*	✓	✓	✓+	✓+	✓+	✓+	✓+	✓+
Non-Marking	✓	✓	✓+	✓+	✓	✓+	✓+	✓+
Durability	✓+	✓	✓	✓+	✓	✓+	✓+	✓+
Cushioned Ride		✓+(soft)	✓	✓	✓+	✓	✓+	✓+
Chemical Resistance	✓+	✓	✓	✓+	✓	✓+	✓+	✓+



Consult factory for RoHS requirements on a part specific basis.

00 Series

Low Profile Casters
CAPACITY UP TO 300 LBS

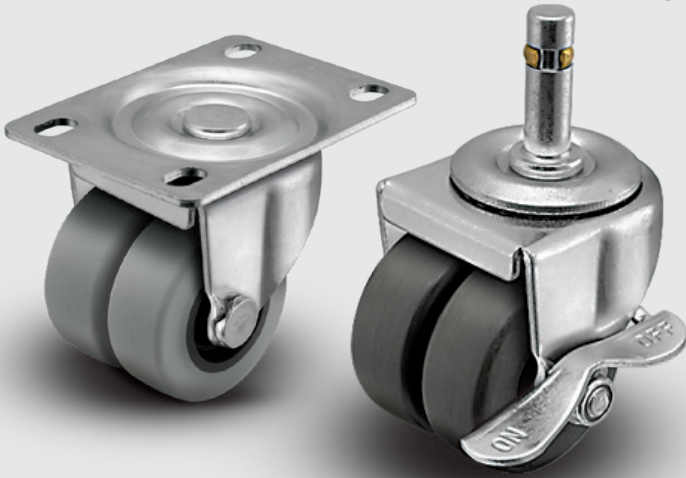

The 00 Series is the perfect solution for a low profile application that requires heavier load capacities. The 00 is available in a dual or single wheel configuration with a variety of wheel types and fastening options to choose from. The low overall height and high load capacities make the 00 a popular caster for store fixtures, electronic equipment, and business machines.

MOUNTING OPTIONS

Threaded Stem

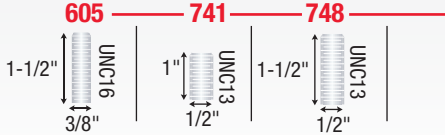

Grip Ring Stem

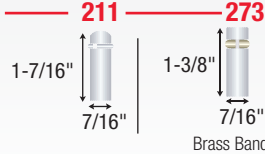

Top Plate

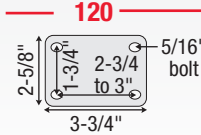

APPLICATIONS

- Electronic Equipment
- Business Machines
- Store Fixtures
- Laboratory Equipment
- Vending Machines
- Dolly Solutions
- Refrigeration Units

OPTIONS

- **Side Lock Brake:** Available on all 2" models. To order, add [B] to end of model.
- **Thumb Screw Brake:** Available by special order; consult factory for details.
- **Finishes:** Zinc plating standard; optional finishes available. Consult factory.

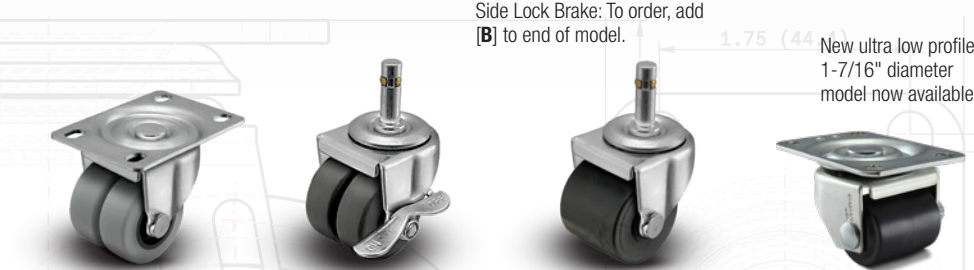

Side Lock Brake: To order, add [B] to end of model.

New ultra low profile 1-7/16" diameter model now available.

SOCKET OPTIONS

Shepherd has many solutions to help you mount your casters to your equipment quickly and easily. See pages 48-49 for more information.



Wheel Selection



Soft Rubber (Dark Grey) | Thermoplastic Rubber TPR (Grey) | Hard Rubber (Loden Grey) | Polyolefin Dual (Black) | Polyolefin Log (Black)

Floor Protection ¹	✓+	✓+	✓	✓	✓
Non-Marking	✓	✓+	✓	✓	✓
Durability	✓	✓	✓	✓+	✓+
Cushioned Ride	✓+	✓			
Chemical Resistance	✓	✓	✓	✓+	✓+



Consult factory for RoHS requirements on a part specific basis.

Ball

Metal Tread Casters

CAPACITY UP TO 100 LBS



FEATURES

- Industry leading selection and overall value
- Fast deliveries for any order quantity
- Self-lubricating acetyl resin bearing
- No exposed axle

APPLICATIONS

- Store Fixtures
- Furniture
- Office Equipment
- Medical Equipment

OPTIONS

- **Tred-Gard®** cover protects tread from scratches during manufacturing and shipping. To order add **[-T]** to end of Part Number. Available for 2" and 2-1/2" models. For field installable Tred-Gards order **001550"** models.

Bright Chrome

Bright Brass

Windsor Antique

Special colors available



SOCKET OPTIONS

Shepherd has many solutions to help you mount your casters to your equipment quickly and easily. See pages 48-49 for more information.



Ball

Soft Tread Casters

CAPACITY UP TO 100 LBS



FEATURES

- Industry leading selection and overall value
- Fast deliveries for any order quantity
- Self-lubricating acetyl resin bearing
- No exposed axle

APPLICATIONS

- Store Fixtures
- Furniture
- Office Equipment
- Medical Equipment

OPTIONS

- **Brake:** 3" diameter models only.
- Unfinished available

Bright Chrome

Bright Brass

Windsor Antique

Special colors such as satin chrome and others available - consult factory for MOQ.

SOCKET OPTIONS

Shepherd has many solutions to help you mount your casters to your equipment quickly and easily. See pages 48-49 for more information.

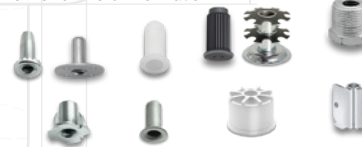

HIGH DUTY

Baron

Hooded Ball Casters

CAPACITY UP TO 80 LBS



FEATURES

- Double ball bearing raceways
- Octagon washer on threaded stem for easy installation
- 2" model is heat treated

APPLICATIONS

- Store Fixtures
- Furniture
- Office Equipment
- Medical Equipment

OPTIONS

- RoHS compliant zinc finish available by special order; please consult factory for details.

WHEEL OPTIONS



2" Spherical Polyolefin

1-5/8" Spherical Soft Rubber

SOCKET OPTIONS

Shepherd has many solutions to help you mount your casters to your equipment quickly and easily.

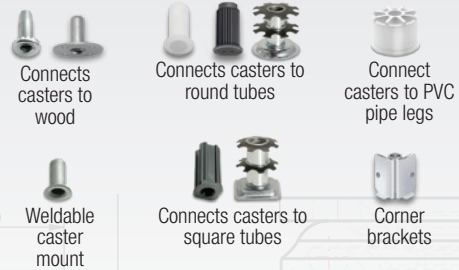

FINISH OPTIONS



Bright Chrome

Bright Brass

Windsor Antique

Threaded

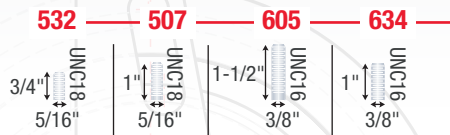

Grip Neck

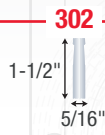

Grip Ring

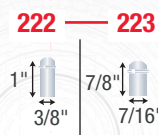

Top Plate

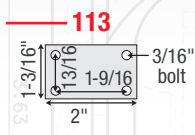

A PARTNER YOU CAN RELY ON



Dependable Supply

With 12 facilities in 9 states across the country, Colson Group has the robust supply chain to be able to meet your needs.



ROHS Compliant

Colson strives to ensure that our products are manufactured without harmful or hazardous materials and exceed RoHS standards to protect the public health and the environment.*



Proven Performance

Our in-house testing capabilities and large team of engineers means you can be sure our products have been tested and proven to your exact requirements

*RoHS compliance can be confirmed on an individual part number basis at the time of acquisition.



ColsonGroupUSA.com